

EXHIBITION HALL UTILITIES

FLOOR BOX UTILITIES:
THREE 100-VOLT, SINGLE-PHASE 20-AMP DUPLEX OUTLETS, AND ONE 200V/100 VOLT THREE-PHASE 60-AMP OUTLET, TELEPHONE, WASTE WATER DRAIN, CABLE TV.

PROVIDED AT CEILING (9' CENTER):
ONE 480/277 VOLT, THREE-PHASE 100-AMP OUTLET, TWO 4" EMPTY CONDUITS TO ALLOW ADDITIONAL SERVICES, COLD WATER, COMPRESSED AIR.

LOCATED IN OVERHEAD STRUCTURE:
480/277 VOLT, THREE-PHASE FOUR WIRE SERVICE, AND 200V/100 VOLT THREE-PHASE FOUR WIRE SERVICE AT EACH BOX.

FE - FIRE EXTINGUISHER
FEC - FIRE EXTINGUISHER IN CABINET

FH - FIRE HOSE VALVE
FEC - FIRE HOSE VALVE IN CABINET

SHRINERS INTERNATIONAL 2023
JULY 1 - JULY 5, 2023
CHARLOTTE CONVENTION CENTER
HALL B
CHARLOTTE, NC



2575 NORTHWEST PKWY
ELGIN, IL 60124
P: 847.426.3100
F: 847.426.3111
www.vipertradeshow.com

DATE
12.12.22

BOOTH COUNTS
ALL BOOTHS ARE 10' X 10'
(UNLESS NOTED)

10 x 10 = 100

KEY
FE-FIRE EQUIPMENT
ALL EXITS 6' UNLESS NOTED
ALL DRAPE USED MEETS
FLAME RETARDANT FIRE CODE

SHOW INFO
SHOW OPENS:
SHOW CLOSES:
MOVE IN:
MOVE OUT:
CONTACT:
PHONE:

CAPACITY INFO
GUESTS: N/A
TOTAL SQ FT: 50000
USABLE SQ FT: 50000
MAX OCCUPANCY: 3333
MAX ALLOWED OCCUPANCY: 3333
EXIT FEET REQ'D: 65'
FIRE EXITS GIVEN: 78
FIRE EXTINGUISHERS REQ: 16
FIRE EXTINGUISHERS GIVEN: 9

DRAWN BY
M. MOSES

SCALE
1" = x UNITS

DISCLAIMER
Every effort has been made to ensure the accuracy of all information contained on this drawing. However, the user of this drawing is responsible for verifying all dimensions and locations. The user is also responsible for ensuring that all equipment and materials are properly installed and maintained. The user is also responsible for ensuring that all safety requirements are met. The user is also responsible for ensuring that all fire exits are clear and unobstructed. The user is also responsible for ensuring that all fire extinguishers are properly maintained and used.

There will be no candles, pyro-technics or open flames that have not been properly permitted used in this event.

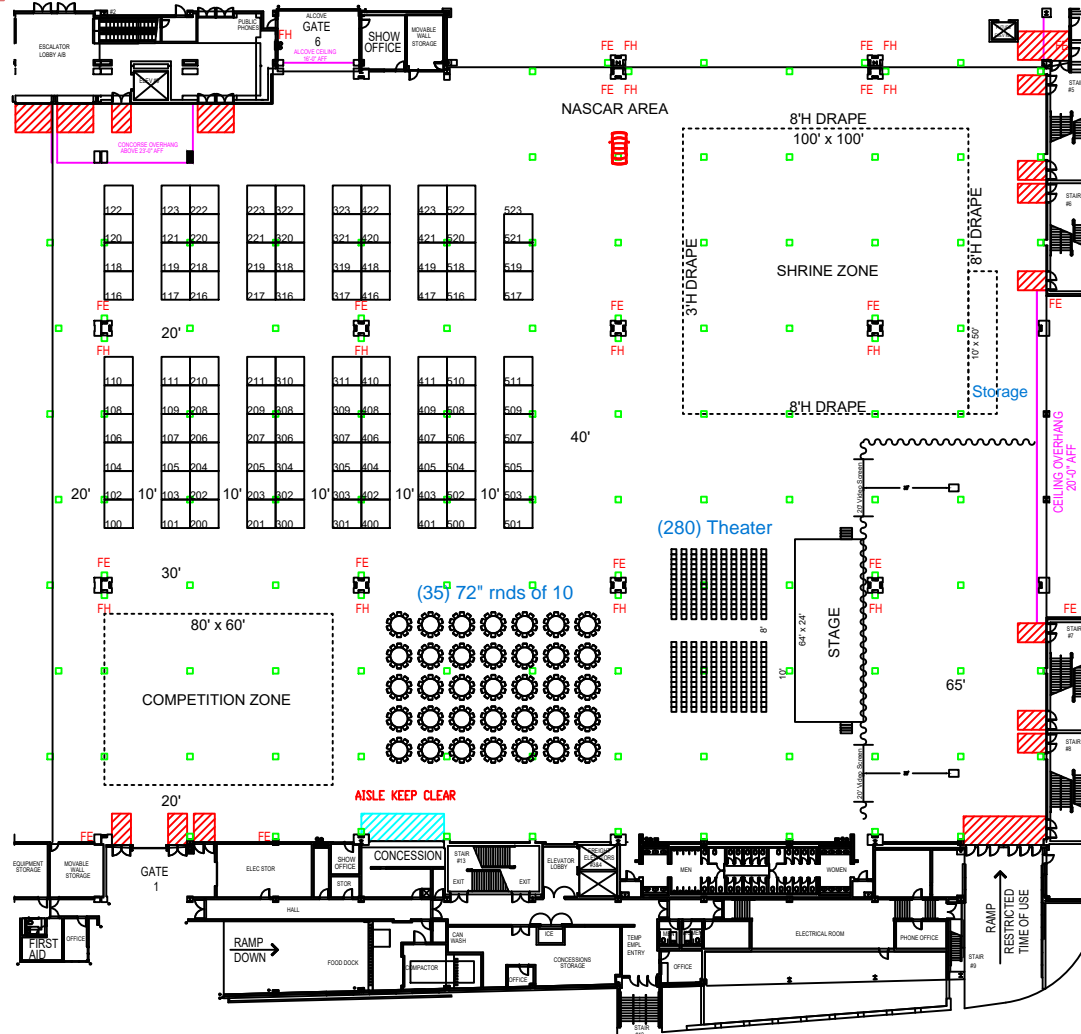

STONEWALL STREET

ROOM
MAX OCCUPANCY 50000 sqft divided by 15 = 3333
Linear footage of exits REQUIRED, 3333 divided by 60 = 55'
Fire Exits Req: 3333 Times .02 = 66'
Fire Exits Given: 78
Fire Extinguishers Req: 50000 sqft divided by 3000 = 16
Fire Extinguishers Given: 9